

NOTES

1. All exploratory hole locations are indicative only and should not be scaled.
2. All Heights are in mAOD

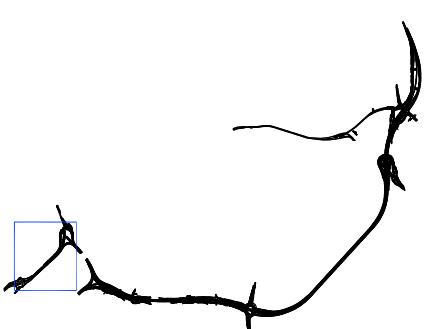

- KEY**
- Phase 6 Borehole
 - Phase 6 Window Sample
 - Phase 4 & 4A Borehole
 - Phase 4 & 4A Window Sample
 - Phase 1 & 2 Borehole

Confidential Material
 Although all highway alignments are indicative only, this information should be treated as strictly confidential and may only be issued to any third parties for tendering purposes with the prior approval of Gifford Consulting Engineers.



Report Title
CONTAMINATED LAND AND GROUNDWATER TECHNICAL ANNEX

Report Number:
MG_REP_EIA_009

Figure Title
REMOTE JUNCTIONS WESTON LINK JUNCTION & M56 JUNCTION 12 GEOLOGICAL CROSS SECTIONS K-K & L-L

Figure Number:
MG_REP_EIA_009/030

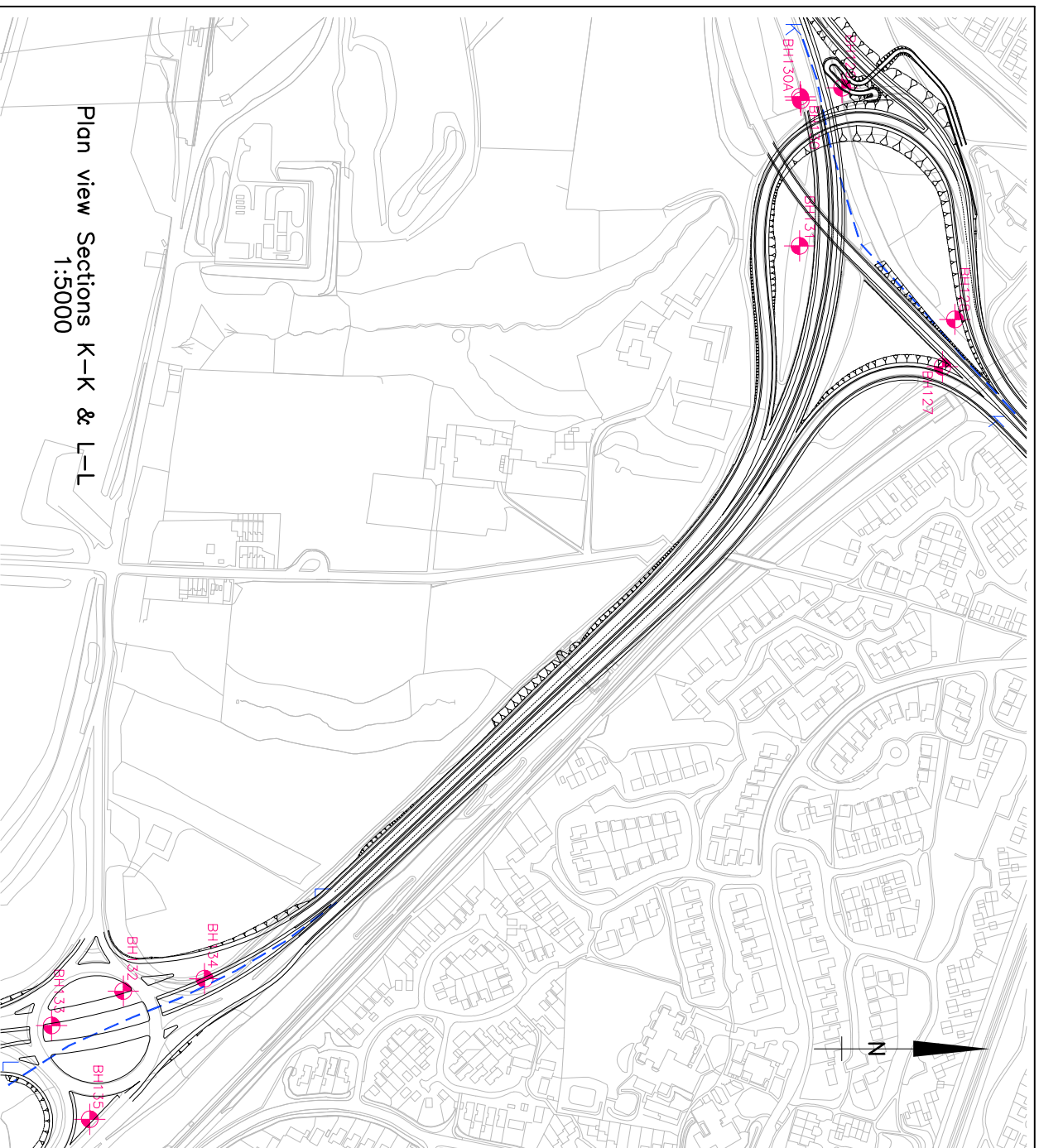

Plan view Sections K-K & L-L
 1:5000

- Legend**
- MADE GROUND
 - ORGANIC / PEAT
 - SILT
 - GRAVEL
 - SAND
 - CLAY
 - SANDSTONE
 - MUDSTONE
 - SILTSTONE
 - COBBLE
 - VOID / OBSTRUCTION
 - NO RECOVERY

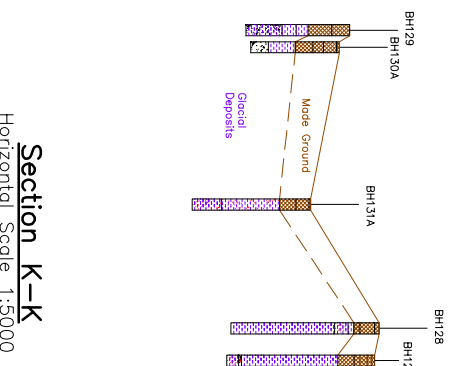
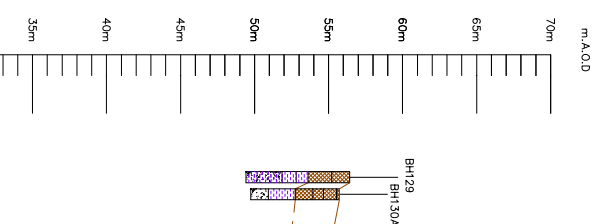

Section K-K

Horizontal Scale 1:5000
 Vertical Scale 1:500

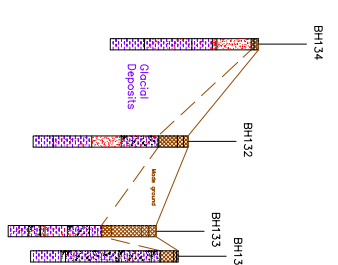
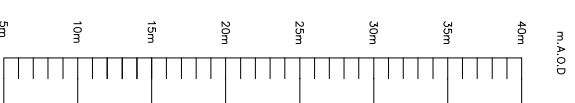
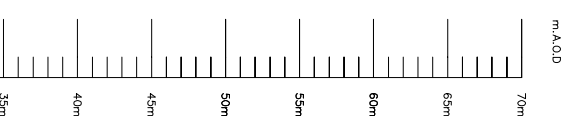

Section L-L

Horizontal Scale 1:5000
 Vertical Scale 1:500

This map is reproduced from Ordnance Survey material with the permission of Ordnance Survey on behalf of the Controller of Her Majesty's Stationery Office. Unauthorised reproduction infringes Crown copyright and may lead to prosecution or civil proceedings. Halton Borough Council Licence No. 100018552 2007.