

WIDNES LOOPS

WIDNES TOLL

WIDNES ON-SLIP

WIDNES SOUTH

WIDNES NORTH

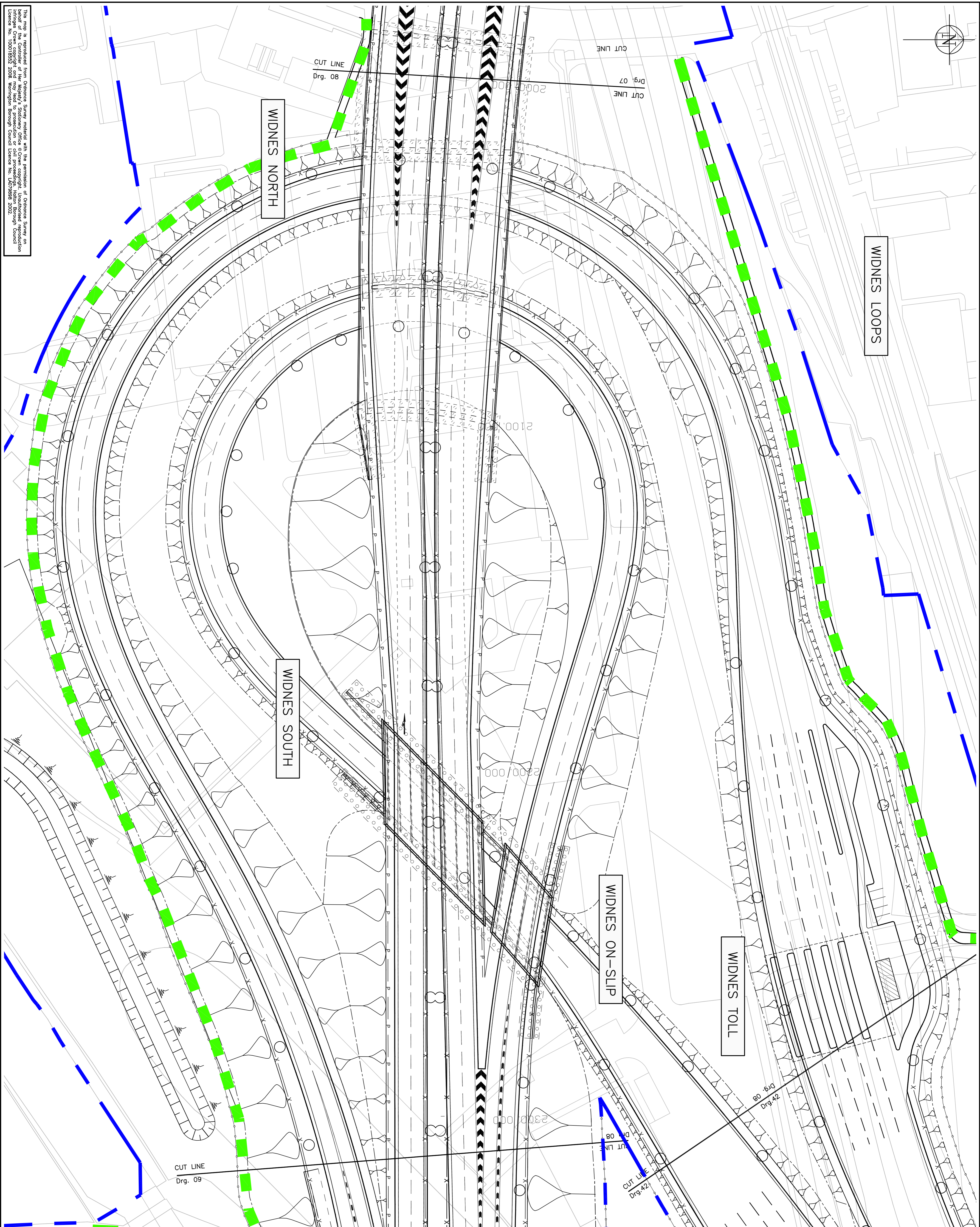

NOTES

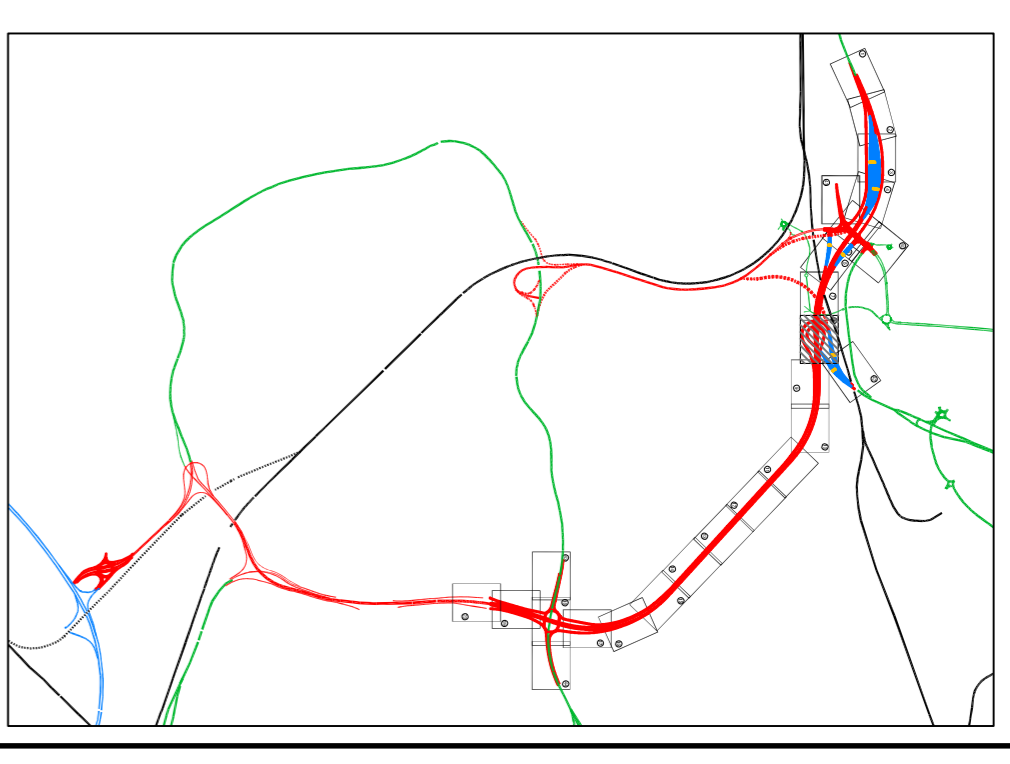

1. This drawing should only be read in relation to the subject of the title. Other information shown on drawing is to be considered indicative only. Reference should be made to appropriate drawing series for other information.
2. Do not scale from this drawing.
3. Balancing pond details to be confirmed.
4. Extent of embankments are indicative only.

Legend

- Boundary fencing
- Single sided barrier
- Parapet
- Vertical concrete barrier
- Twin lighting column
- Single lighting column
- Balancing pond
- Redundant Carriseway and removal
- Footway/cycleway
- TMA boundary
- Planning application boundary

PLANNING DIRECTION

Rev.	BAH
Drawn	JMB
Apprvd	SWJ
Date	16.05.08



Project
**THE RIVER MERSEY
 (MERSEY GATEWAY BRIDGE)
 ORDER**

Drawing Title
**PLANNING DIRECTION
 GENERAL ARRANGEMENT
 SHEET 8 OF 25**

Gifford

20 Nicholas Street, Chester, CH1 2NX
 Tel: 01244 31955 Fax: 01244 31959 www.gifford.com

Scale (at A1)	Date	Drawn
1:500	March 08	BAH

Dwg no. **B4027/4/H/100/08**

This map is reproduced from Ordnance Survey material with the permission of Ordnance Survey on behalf of the Controller of Her Majesty's Stationery Office copyright. Unauthorised reproduction of this map is illegal. Ordnance Survey is a registered trademark of Ordnance Survey Limited. Licence No. 10001852/2008. Warrington Borough Council Licence No. LA079889/2002.

10 0 10 20 50
 100mm NATURAL SCALE